

TROUBLE SHOOTING & SUPPORT

Problem - Rotor won't move.

- Has the rechargeable Internal Battery been fully charged?
- Make certain that the drone ON/OFF switch is in the "ON" position.

Problem - Drone has slow reaction to hand, hits hand before moving or suddenly stops and drops when flying.

- Low battery. Recharge the battery according to the instructions.

Problem - Loss of control.

- Lighting is too bright and the sensor can not detect objects.

Problem - Drone does not fly up in a straight line.

- Check there is no air turbulence indoors, such as a fan or open window with strong breeze.

BATTERY SAFETY INFORMATION:

- Only batteries of the same or equivalent type as recommended are to be used.
- Dispose of batteries safely and correctly.
- Non-rechargeable batteries are not to be recharged.
- This toy contains no-replaceable rechargeable battery.
- Switch Drone OFF when not in use.

CAUTION:

Do not dispose batteries in fire. Leakage, explosion and personal injury may occur.

Do not recharge internal battery if toy is hot or warm to the touch. Allow battery to cool before recharging.

Recharging a hot or warm battery will shorten the life of the unit.

Do not recharge the internal battery if it appears to be damaged or leaking.

Do not attempt to disassemble or remove internal battery.

Only an adult should charge batteries.

This toy is intended for indoor use only.

Do not use included USB Cord for anything other than its intended purpose.

Choking hazard. Keep small batteries away from children.

The reception performance may be affected under a strong interference disturbance environment.

This product would not perform normally under a strong electrostatic environment.

WARNING:

Always operate the toy away from face or eyes.

F.C.C. CAUTION:

Changes or modifications not expressly approved by the party responsible for compliance could void the user's authority to operate the equipment.

This device complies with Part 15 of the FCC Rules. Operation is subject to the following two conditions:

- (1) this device may not cause harmful interference, and (2) this device must accept any interference received, including interference that may cause undesired operation.

NOTE:

This equipment has been tested and found to comply with the limits for a Class B digital device, pursuant to Part 15 of the FCC Rules. These limits are designed to provide reasonable protection against harmful interference in a residential installation. This equipment generates, uses and can radiate radio frequency energy and, if not installed and used in accordance with the instructions, may cause harmful interference to radio communications. However, there is no guarantee that interference will not occur in a particular installation. If this equipment does cause harmful interference to radio or television reception, which can be determined by turning the equipment off and on, the user is encouraged to try to correct the interference by one or more of the following measures:

- Reorient or relocate the receiving antenna.
- Increase the separation between the equipment and receiver.
- Connect the equipment into an outlet on a circuit different from that to which the receiver is connected.
- Consult the dealer or an experienced radio/TV technician for help.



OWNER'S MANUAL

Please read and understand all precautions prior to use.

Thank you for choosing a premium New Bright product.

USA & Canada

30-Day Limited Warranty

New Bright Industries warrants to the original purchaser that this product will be free of defects in materials and workmanship for thirty (30) days from the date of purchase. In the event of such defect within the warranty period, New Bright will repair or replace the product at our sole discretion. This warranty does not cover damage resulting from unauthorized modifications, accident, misuse or abuse.

Should your item have a defect covered under this warranty, first call the toll free number listed below. Most problems can be resolved in this manner. If necessary, you will be issued a Return Authorization number (RA) and instructions on how to obtain a Product Return Form. The Product Return Form is to be used when returning a product to us (postage pre-paid and insured by the consumer).

When returning a defective product, please package the product, the Product Return Form and a copy of the dated sales receipt as proof of purchase. Be sure to mark the RA number on the Product Return Form. If the product is returned without a dated sales receipt, it will be excluded from coverage under this warranty. Please allow 4 to 6 weeks for delivery of repaired or replacement vehicles (depending on your location).

New Bright Industries' liability for defects in materials and workmanship under this warranty shall be limited to repair or replacement at our sole discretion. In no event shall we be responsible for incidental, consequential or contingent damages (except in those states that do not allow this exclusion or limitation).

Valid only in the USA & Canada.

Contact New Bright Industries Customer Service Toll Free at:

1-877-NBI-TOYS

(1-877-624-8697)

Monday through Friday, 8:00 AM to 5:00 PM Eastern Time

U.S. Toy Sales and Marketing Co. Inc.

30260 Oak Creek Drive – 2nd Floor

Wixom MI 48393

1-877-624-8697

<http://www.newbright.com/>

This toy contains
battery that is
non-replaceable.

REF-U1608

JN167-24

COMPONENT CHECKLIST

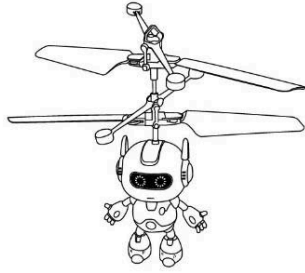

1



1

HAND DRONE OPERATING

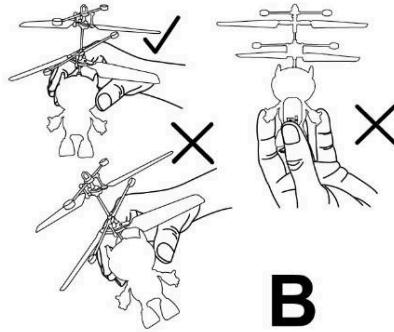
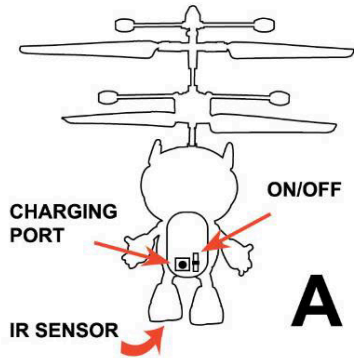

Before first use, make sure to charge the drone. See Charging Instructions.

Note:

For indoor use only.

Instructions:

1. Turn Power on. See Diagram A.
2. LED light will turn on to indicate the drone is turned on and ready to fly.
3. Hold the drone upright as shown in Diagram B, making sure not to cover the sensor located on the bottom. Sensor location shown in Diagram A.
4. Be sure to keep your fingers out of the way of the rotor blades.
5. After 3 seconds the rotor blades will begin to spin.
6. Let go of the drone and place your hand underneath it. The drone will hover up and down as it senses objects beneath it.
7. Moving your hand closer to the drone will cause the drone to fly upward.
8. Lower your hand and the drone will descend. Remove your hand and the drone will slowly descend until it senses another object or the floor and will hover just above the surface.
9. To turn off, quickly and carefully grab the drone as shown in Diagram B, making sure not to place your hand under the sensor.

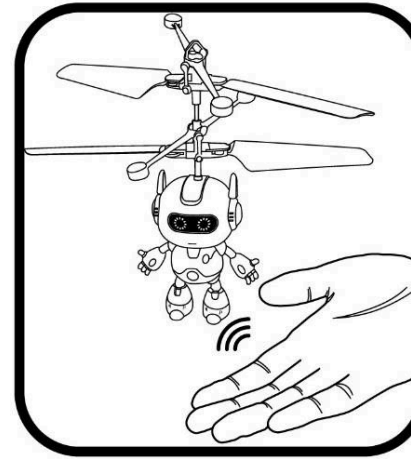

Moving your hand closer to the drone will cause the drone to fly upward.

CHARGING INSTRUCTIONS

Operation:

1. Turn off the drone by moving the power switch to the OFF position. See diagram A.
2. Plug the USB Charging Cord into the drone via the charging port shown in Diagram A.
3. Insert the USB end in to any powered 5V DC USB port.
4. A red charging status light will turn on while charging. The light will turn off when charging is complete. Full charge takes approximately 30 minutes.
5. During play, the red light will flash when the battery needs charging.

