

**CAUTION-ELECTRICALLY OPERATED PRODUCT:**  
NOT RECOMMENDED FOR CHILDREN UNDER 8 YEARS OF AGE.  
AS WITH ALL ELECTRIC PRODUCTS, PRECAUTIONS SHOULD BE  
OBSERVED DURING HANDLING AND USE TO PREVENT ELECTRIC  
SHOCK. INPUT: 120V AC 60Hz 15W. OUTPUT: 14.4V DC 700mA.



# OWNER'S MANUAL

*Please read and understand all precautions prior to use.*

**Thank you for choosing a premium New Bright product.**

## **USA & Canada 30-Day Limited Warranty**

New Bright Industries warrants to the original purchaser that this product will be free of defects in materials and workmanship for thirty (30) days from the date of purchase. In the event of such defect within the warranty period, New Bright will repair or replace the product at our sole discretion. This warranty does not cover damage resulting from unauthorized modifications, accident, misuse or abuse.

Should your item have a defect covered under this warranty, first call the toll free number listed below. Most problems can be resolved in this manner. If necessary, you will be issued a Return Authorization (RA) number and instructions on how to obtain a Product Return Form. The Product Return Form is to be used when returning a product to us (postage pre-paid and insured by the consumer).

When returning a defective product, please package the product, the Product Return Form and a copy of the dated sales receipt as proof of purchase. Be sure to mark the RA number on the Product Return Form. If the product is returned without a dated sales receipt, it will be excluded from coverage under this warranty. Please allow 4 to 6 weeks for delivery of repaired or replacement robots (depending on your location).

New Bright Industries' liability for defects in materials and workmanship under this warranty shall be limited to repair or replacement at our sole discretion. In no event shall we be responsible for incidental, consequential or contingent damages (except in those states that do not allow this exclusion or limitation).

### **Valid only in the USA & Canada.**

Contact New Bright Industries Customer Service Toll Free at:

1-877-NBI-TOYS

(1-877-624-8697)

Monday through Friday, 8:00 AM to 5:00 PM Eastern Time

## Component Checklist

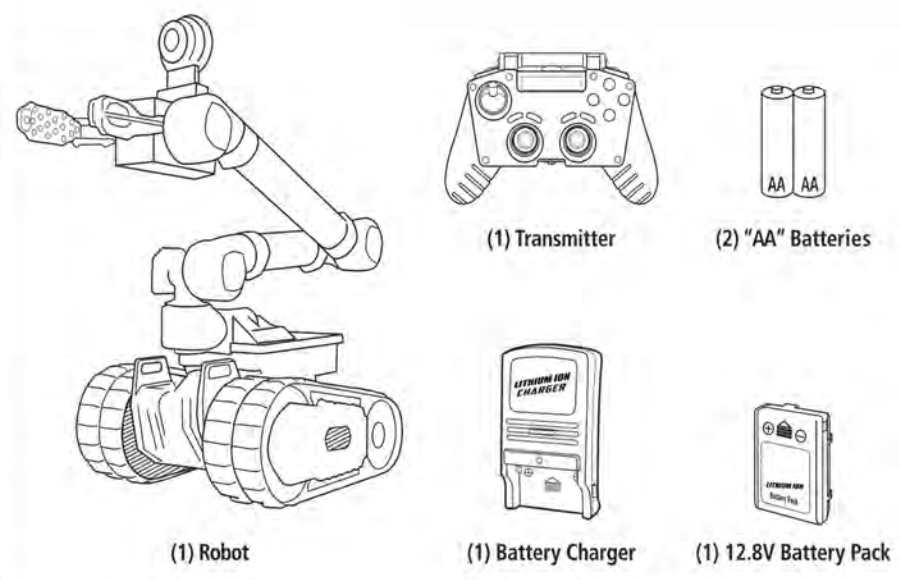

## CAUTION!

- Do not recharge Battery Pack if it is hot or warm to the touch. Allow Battery Pack to cool before recharging. Recharging a hot or warm Battery Pack will shorten the life of the Pack.
- Do not recharge a Battery Pack if it appears to be damaged or leaking.
- Always unplug Charger when not in use.
- Always remove Battery Pack from Battery Compartment when not in use.
- Do not dispose batteries in fire. Leakage, explosion and personal injury may occur.
- Dispose of Lithium Ion Battery Pack properly.
- Do not attempt to disassemble Battery Pack or Charger.
- Do not use Battery Charger for any use other than instructed in this booklet.
- Only an adult should charge Batteries.
- Do not attempt jumps or tricks with this robot.

## Charging

**IMPORTANT!**  
The included 12.8V Lithium Ion battery pack is only **PARTIALLY CHARGED** prior to shipment and it is recommended the battery be fully charged before first use.

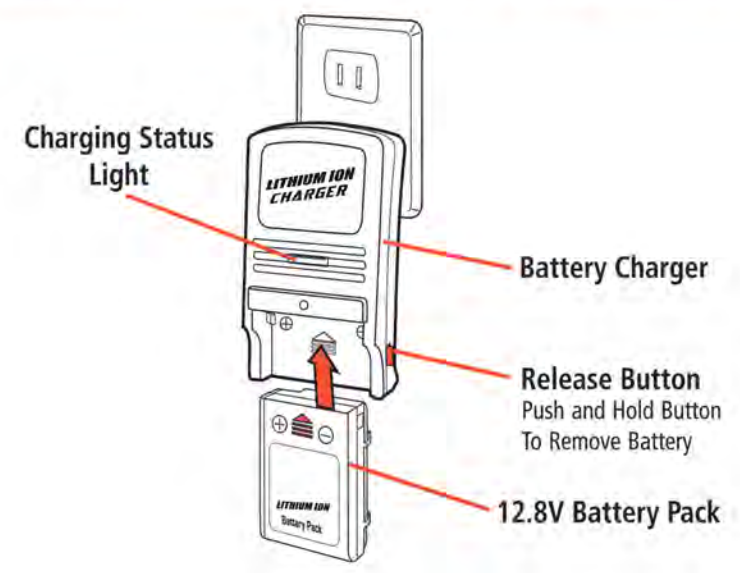

1. Insert the 12.8V Lithium Ion rechargeable battery pack securely into the charger and push up to lock. Be sure the arrows are properly matched (as shown above).
2. Plug the Charger into a standard indoor electrical outlet. This power unit is intended to be correctly orientated in a vertical or wall mount position.
3. Allow battery to charge for 1-1.5 Hours. Charging Status Light will be solid red while battery is charging. When charging is complete, light will blink green.
4. To remove the battery, press and hold the release button and slide battery down to unlock.
5. Charge will last approximately 20-30 minutes depending on terrain and driving style.

**IMPORTANT:** It is normal for the battery pack to become warm after charging and/or use. Be sure to allow the battery pack to cool before using or recharging. Recharging a warm battery pack will greatly reduce the battery life.

### ATTENTION PARENTS:

- The Battery Charger & Battery Pack need to be periodically examined for potential hazards. Any potentially hazardous parts need to be repaired or replaced.

# TRANSMITTER

3

## Battery Installation

1. Flip smart phone holder up to reveal battery compartment.
2. Press and slide in the direction of the arrow open battery compartment cover.

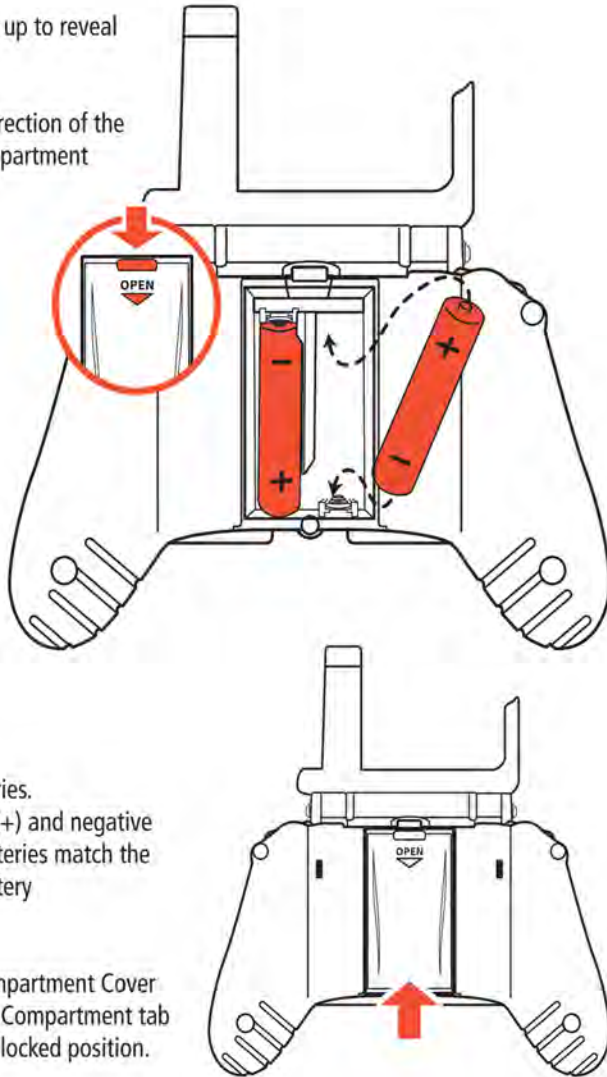

3. Insert 2 "AA" size batteries. Make sure the positive (+) and negative (-) markings on the batteries match the markings inside the Battery Compartment.
4. Replace the Battery Compartment Cover making certain that the Compartment tab has "snapped" into the locked position.

**Note:** When replacing Transmitter batteries:  
Do not mix old and new batteries.  
Do not mix alkaline, standard or rechargeable batteries.  
Use alkaline batteries only.

# VEHICLE

4

## Battery Installation

Locate and align arrow on battery pack with arrow inside battery compartment. Place battery pack in battery compartment and slide battery forward in direction of arrow. Once in place, turn locking tab to keep battery pack secure.\*

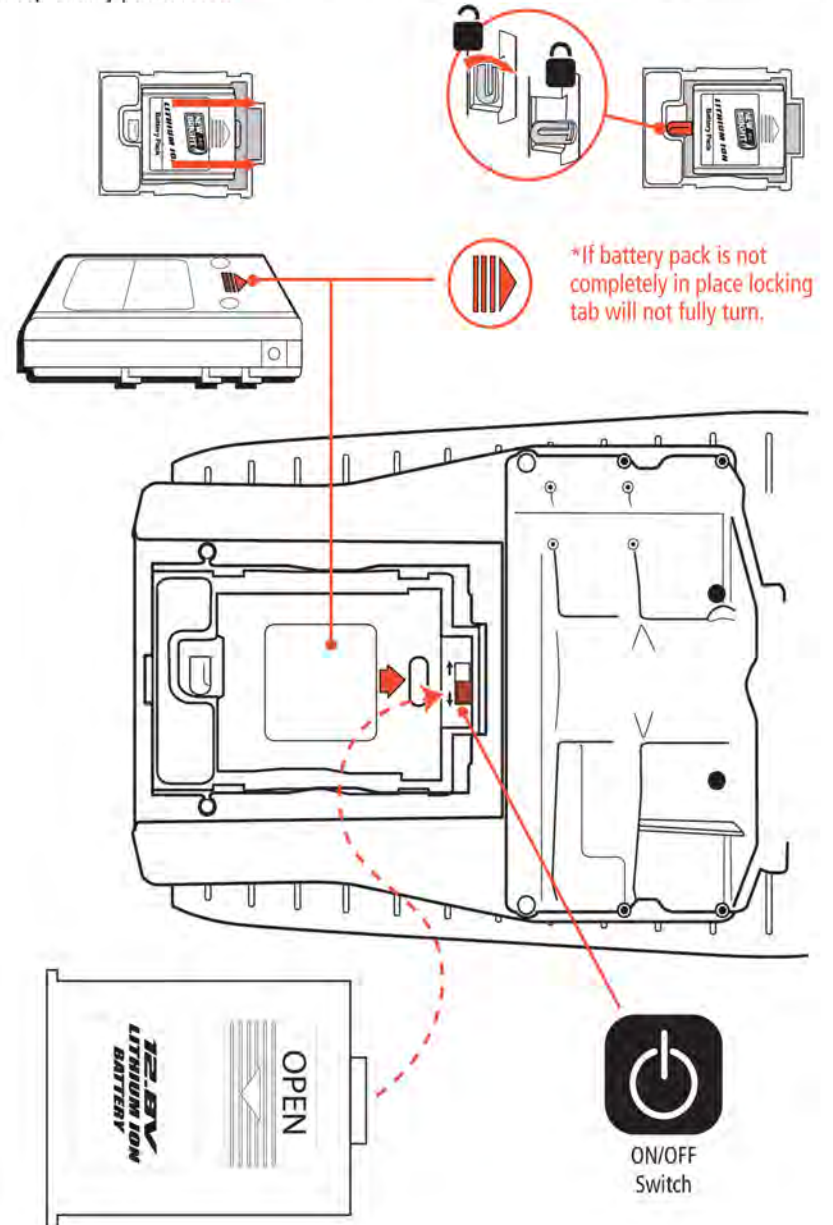

## APP

Operation of the iRobot camera requires the user to download/install the FREE New Bright iRobot app onto an existing smart device.



Apple Users: Search "New Bright iRobot" in the App Store; Download.



Android™ Users: Search "New Bright iRobot" in Android Market or Google Play; Download.

## Camera Set Up

1. Install batteries in transmitter (See instructions on page 3).
2. Install a fully charged battery pack into robot and move switch to the "ON" position (See instructions on page 4).

3. Press "Camera On" button on Transmitter. A red LED light under the camera lens will be illuminated while camera is setting up. Robot will beep while a connection is being established (It may take up to 20 seconds for the first beep). After a short pause (approx. 20 seconds), Robot will continue to beep every 3 seconds while connecting.

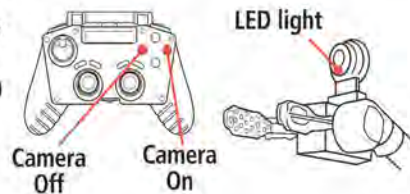

4. Once a connection has been made, the Robot will make 3 rapid beeps. The LED light will flash and then turn off. The camera is now ready for use.

5. Locate and select the camera's WiFi address on your smart device (WiFi address can be found on the backside of the camera).



6. Once a secure WiFi connection is made launch the New Bright iRobot App on your smart device and select "New Bright iRobot".



7. The Camera is now streaming a live video feed to your smart device. You can now attach your device using the bracket mount on top of the transmitter. (See instructions on page 7 item number 8)

Complete app features can be found at [www.newbright.com](http://www.newbright.com)

## Control Map

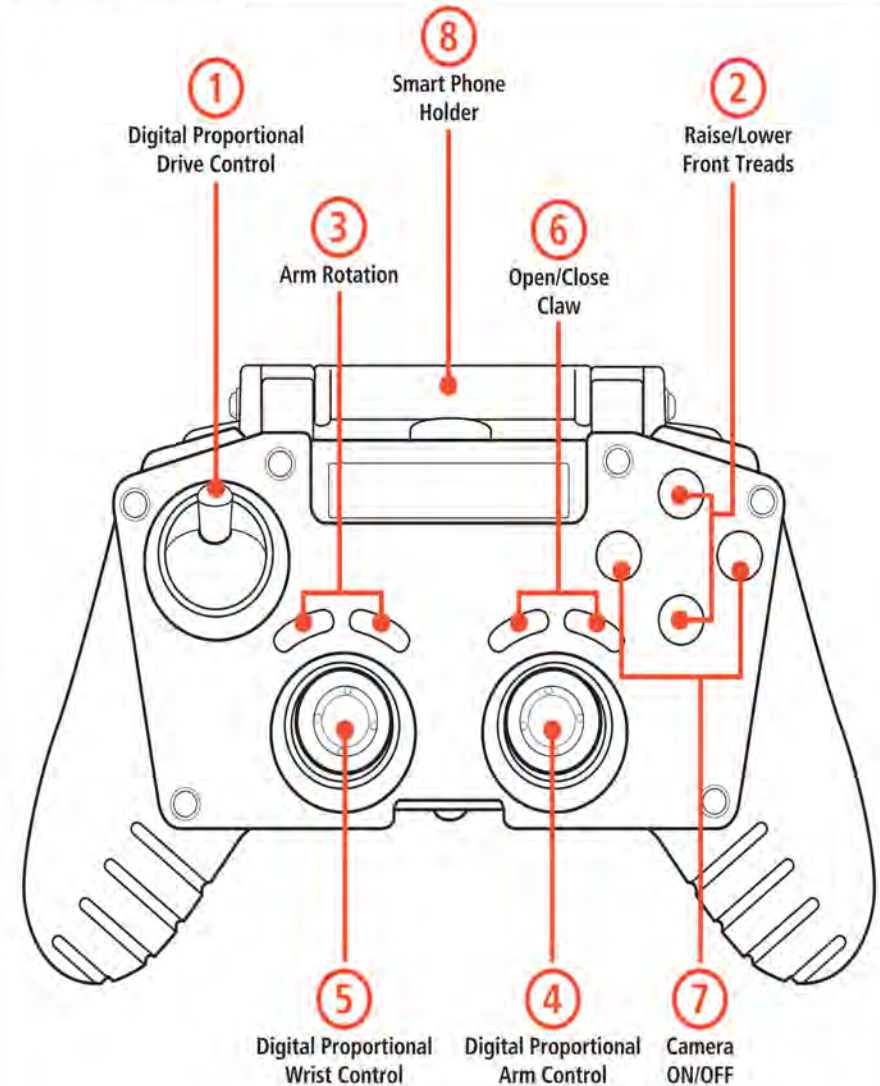

## Syncing

This transmitter is equipped with 2.4GHz technology which allows up to 12 robots to be raced at the same time.

Once robot and transmitter batteries have been correctly installed and robot ON/OFF Switch is in the ON position, the transmitter will automatically sync with the robot.

## Control Details

- 1 Digital Proportional Drive Control**  
 Push Joystick Forward for Forward Driving. Pull Joystick Back for Reverse Driving. Push Joystick Left for Left Turning. Push Joystick Right for Right Turning.
- 2 Raise/Lower Front Treads**  
 Push and hold Top Button to Raise the front treads. Continue to hold to rotate treads 180° for Storage Mode. Push and hold Bottom Button to lower front treads. Continue to hold to lift robot up. Release buttons to stop.
- 3 Arm Rotation**  
 Push and hold Left Button to Rotate Arm Left. Push and hold Right Button to Rotate Arm Right. Release buttons to stop rotation.
- 4 Digital Proportional Arm Control**  
 Push Joystick Forward to Raise Arm. Pull Joystick Back to Lower Arm. Push Joystick Right to Move Arm Forward. Push Joystick Left to move arm Backward.
- 5 Digital Proportional Wrist Control**  
 Push Joystick Forward to Raise Wrist. Pull Joystick Back to Lower Wrist. Push Joystick Right to Rotate Claw Clockwise. Push Joystick Left to Rotate Wrist Counter-Clockwise.
- 6 Open/Close Claw**  
 Push and Hold Left Button to Open Claw. Push and Hold Right Button to Close Claw. Release Buttons to Stop.
- 7 Camera ON/OFF**
- 8 Smart Phone Holder**  
 Locate the Smart Phone Holder at the back of the transmitter. Flip forward into the upright position. Next, gently pull up on the clamp while sliding phone in. Release clamp when phone is in place.

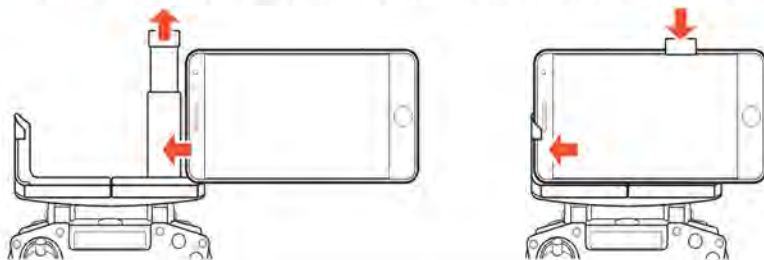

## Function Locations

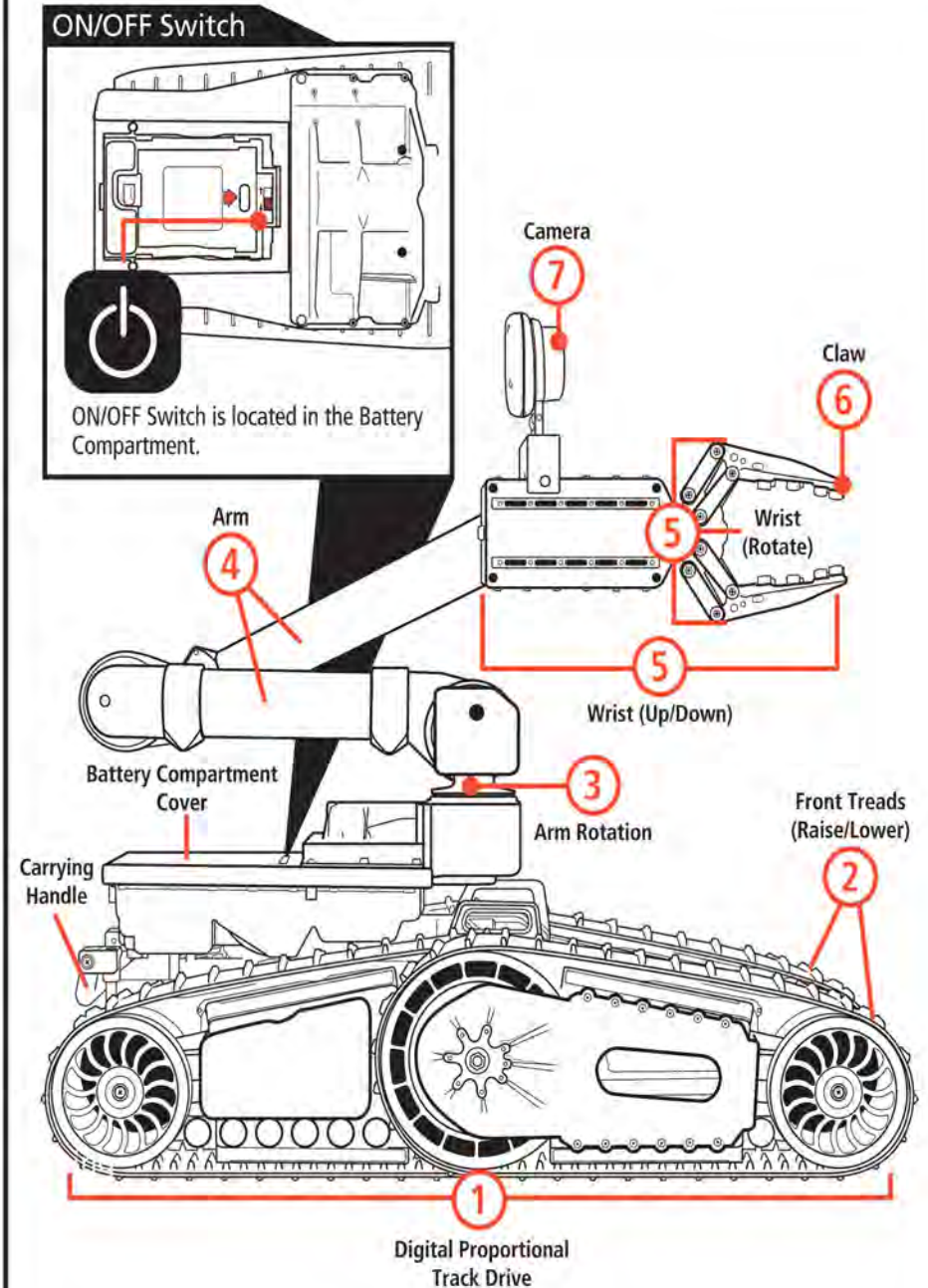

## Basic Controls

### 1 Digital Proportional Track Drive



### 2 Raise/Lower Front Treads



### 3 Arm Rotation



### 4 Arm Control

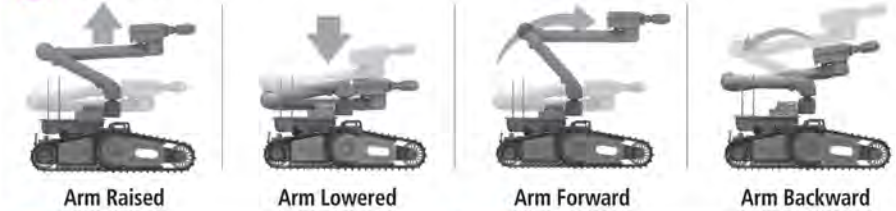

### 5 Wrist Up/Down



### 5 Wrist Rotation



### 6 Claw Open/Close



## Operations

### SIMULTANEOUS MOVEMENTS

To master controls, try out the different movement combinations listed below.

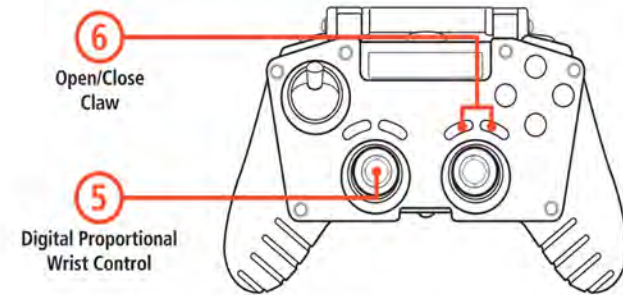

### WRIST & CLAW COMBINATIONS

Press and hold the indicated joystick and button(s). Use this combination to rotate or move the wrist up and down while opening or closing the claw. This maneuver is useful for picking up objects.

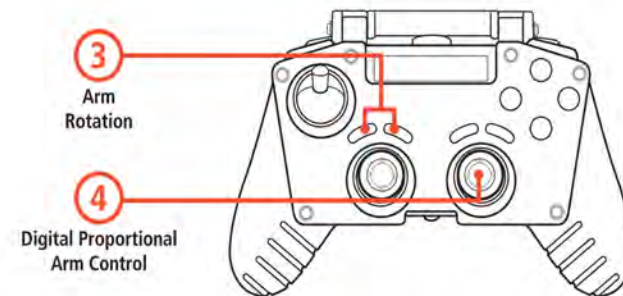

### ARM COMBINATIONS

Press and hold the indicated joystick and button(s). Use this combination to rotate the arm while raising or lowering it, or while moving it forward or backward. This maneuver is useful for reaching.

## Operations

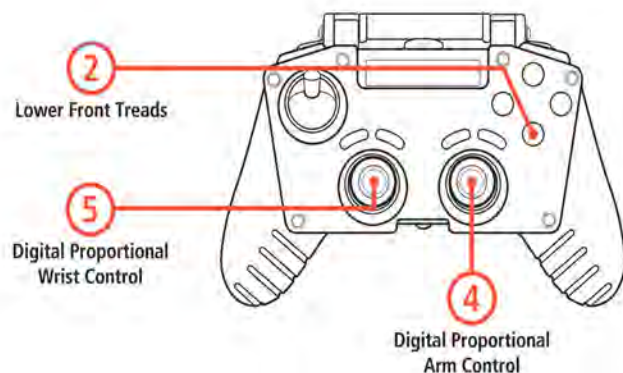
**WRIST, ARM & TREAD COMBINATION**

Press forward on the indicated joysticks while pressing the indicated button. Use this combination to lower the front treads while raising the arm and wrist. This maneuver is useful for reaching high places.

## Troubleshooting

**Problem - Robot does not move or moves slowly.**

- Has the Battery Pack been installed in the robot?
- Has the rechargeable Battery Pack been fully charged?
- Are the metal contact tabs touching, rusty or dirty in the battery compartment?
- Make certain there are fresh alkaline batteries in the transmitter and that they have been installed in the correct position.
- Are the (+) and (-) markings on the alkaline batteries in the same position as the (+) and (-) markings in the Transmitter Battery Compartment?
- Are the (+) and (-) markings on the Battery Pack in the same position as the (+) and (-) markings in the Battery Compartment?
- Make certain that the robot ON/OFF switch is in the "ON" position.

**Problem - Camera image not showing up on smart phone.**

- Is the WiFi enabled on the device?
- Has the camera app been installed on the device?
- Is WiFi available in the area and working properly?
- Has the camera WiFi address been properly entered?

**Problem - Robot moves by itself or exhibits reduced range from the transmitter.**

- Make certain there is no outside radio interference in your area. The best way to test this is to take the robot as far away from radio towers, electrical lines or tall buildings as possible to ensure no further radio interference will occur.

**Pro Tip:**

Proceed slowly and make minor adjustments to your position as you go. Climbing should not be attempted at high speeds.

Precautions & Care

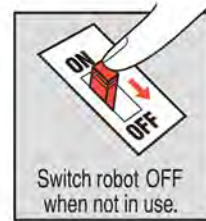
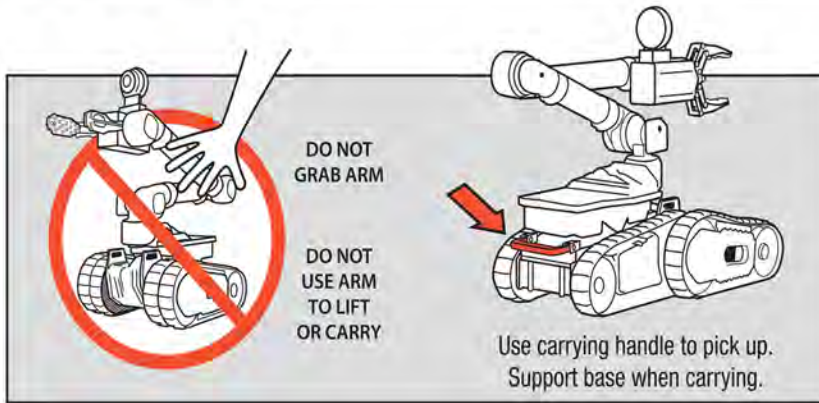

**FCC CAUTION:**

Changes or modifications not expressly approved by the party responsible for compliance could void the user's authority to operate the equipment.

**NOTE:** This equipment has been tested and found to comply with the limits for a Class B digital device, pursuant to Part 15 of the FCC Rules. These limits are designed to provide reasonable protection against harmful interference in a residential installation. This equipment generates, uses and can radiate radio frequency energy and, if not installed and used in accordance with the instructions, may cause harmful interference to radio communications. However, there is no guarantee that interference will not occur in a particular installation. If this equipment does cause harmful interference to radio or television reception, which can be determined by turning the equipment off and on, the user is encouraged to try to correct the interference by one or more of the following measures:

- Reorient or relocate the receiving antenna.
- Increase the separation between the equipment and receiver.
- Connect the equipment into an outlet on a circuit different from that to which the receiver is connected.
- Consult the dealer or an experienced radio/TV technician for help.